

KTSync CAM (KTSync with Software Decoder)

➤ Download & Installation

1. Go to Play Store and search by the app name "KTSync CAM". Download and install KTSync CAM on your phone.
2. When you open or run KTSync CAM for the first time on your phone, there are several permission popups, which require you to allow them all.

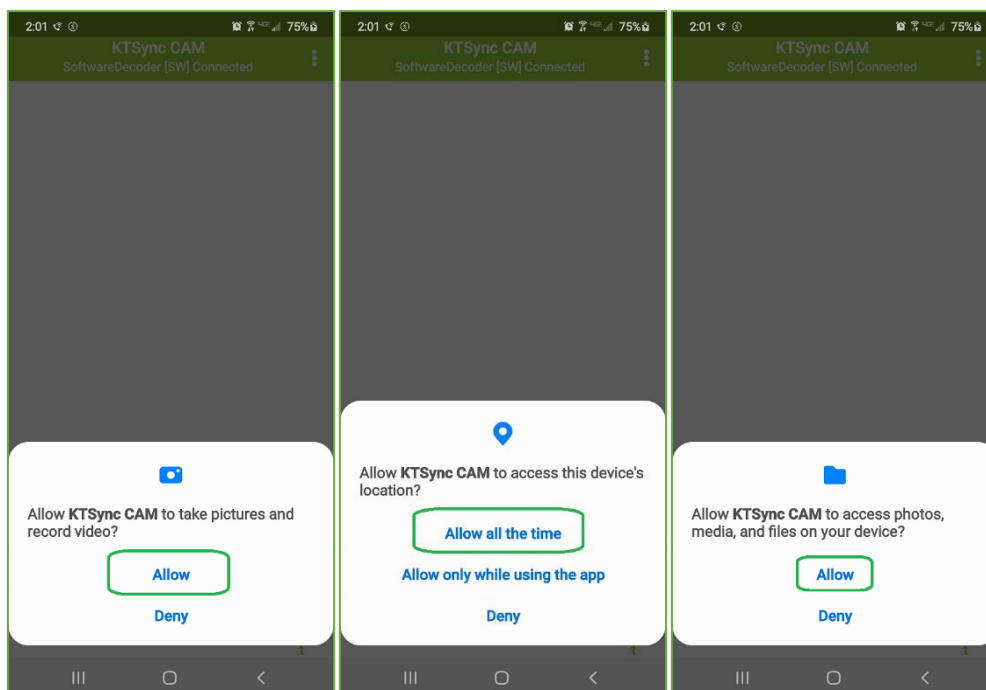

3. If you already purchased and put the (trial) license, then skip to step 8. Otherwise continue.
4. To use the software scanner, you should purchase the activation code from <https://koamtacon.com/kdc8-software-decoder/>. Or you can get the trial activation code from the same site for one-month free trial.
5. To get the activation code, you should sign up first.
6. Once you sign up and purchase the activation code per your plan (trial plan, monthly plan, yearly plan, or unlimited plan), the trial or purchased activation code will be sent out to your email registered during sign up. (Please do not lose the activation code.)

← → ↻ koamtacon.com/kdc8-software-decoder/ ☆

+1 609.256.4700 | koamtacon@koamtac.com | Sign Up | Sign In

KOAMTACON

KDC8 Software Decoder

Fast > Reliable > Accurate > Versatile

Collect barcode data using your smart device's built-in camera.

Los Angeles, CA 94025

Sign Up

The KDC8 software decoder fills the gap between low-quality free barcode decoding software and professional-

Sign Up

All fields are mandatory, except site URL.

KDC Mobile Data Management Suite can be used after signing up as a member and after sending an administrator-approved email.

KDC8 Software Decoder

*User ID

ID DUPLICATION CHECK

- ID must be between 8 – 15 characters.
- ID can contain letters, numbers, or period.
- ID must contain at least one letter.
- ID is case-sensitive.

* Email

* Name

* Password



* Confirm Password

* Phone Number

* Company Name

URL of your site(optional)

-- * Select your country. --

SUBMIT

KOAMTAC (Android) KTSync CAM (SW Decoder) On-screen Keyboard

- Once you receive the activation code by email, you should register the activation code to the KTSync CAM.

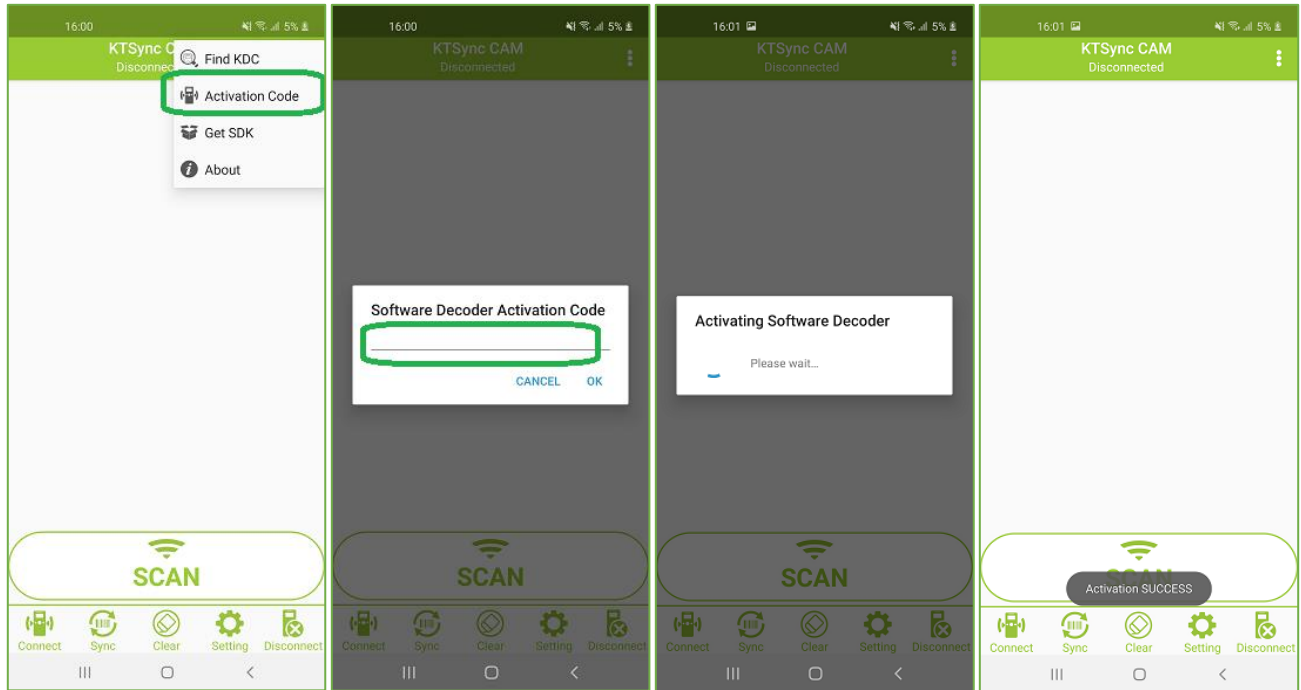

- The phone/tablet will automatically connect to the KDC8 (SW Decoder).
- If not connected automatically, tap on "Connect" menu at the bottom and select a right device: **KDC8 [SW]** in this case.
- If you can see the connected message on the top, you are able to scan it. For testing purpose, scan any barcode and see if it is displayed on the KTSync display screen.

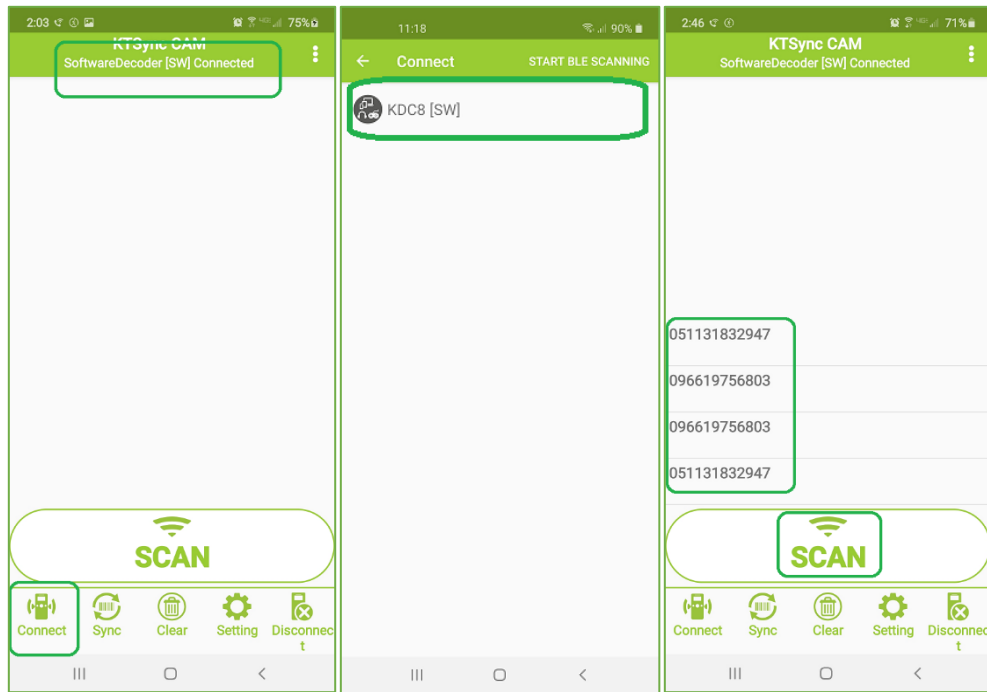

➤ Options (Software Decoder Settings)

1. If you go to Software Decoder Settings from Settings, there are two options: Scan Type and Symbology
2. Scan Type: you can scan a barcode one at a time (Single Scan) or you can continue to scan barcodes (Continuous Scan)
3. Symbology: you scan select or deselected any symbology you want to or do not want to read

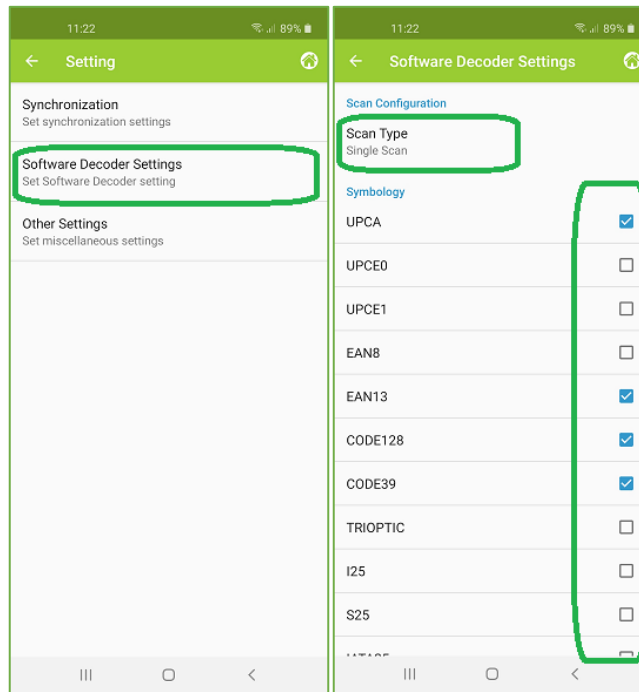

KOAMTAC (Android) KTSync CAM (SW Decoder) On-screen Keyboard

KTSync CAM Keyboard (On-screen Keyboard using KTSync CAM)

➤ Set up on-screen keyboard

1. Go to the phone's or tablet's Settings > General management > Language and Input > On-screen keyboard > Manage keyboards. Find KTSync CAM keyboard and enable it by sliding the button to the right. Go back to Language and input or On-screen keyboard depending on the phone's or tablet's OS version. And then go to Default keyboard and change the default keyboard from the other keyboard to KTSync Keyboard.

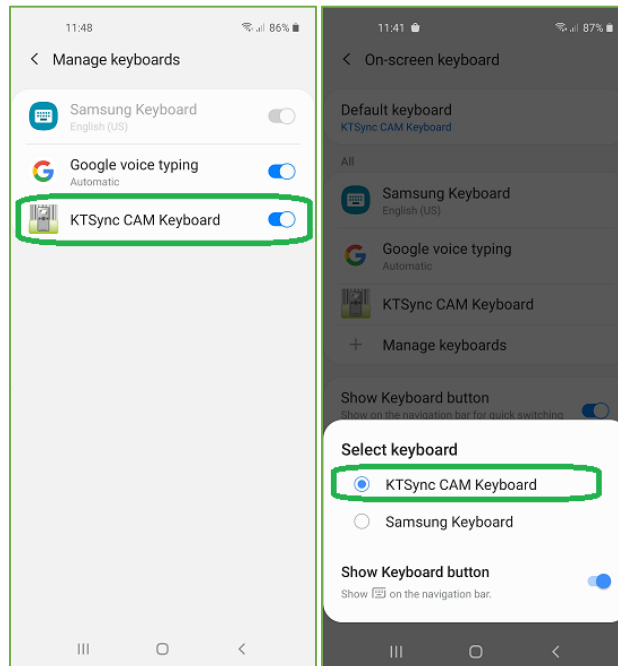

2. To switch back to the other keyboard, simply change the default keyboard again. Or, when a text field is selected, swipe down from the top of the screen to bring up the notification panel. Select 'Select keyboard' and you can change the default keyboard from here. (Fig. 2) Or, select keyboard button from the navigation bar and you can change the default keyboard from here. (Fig. 3)

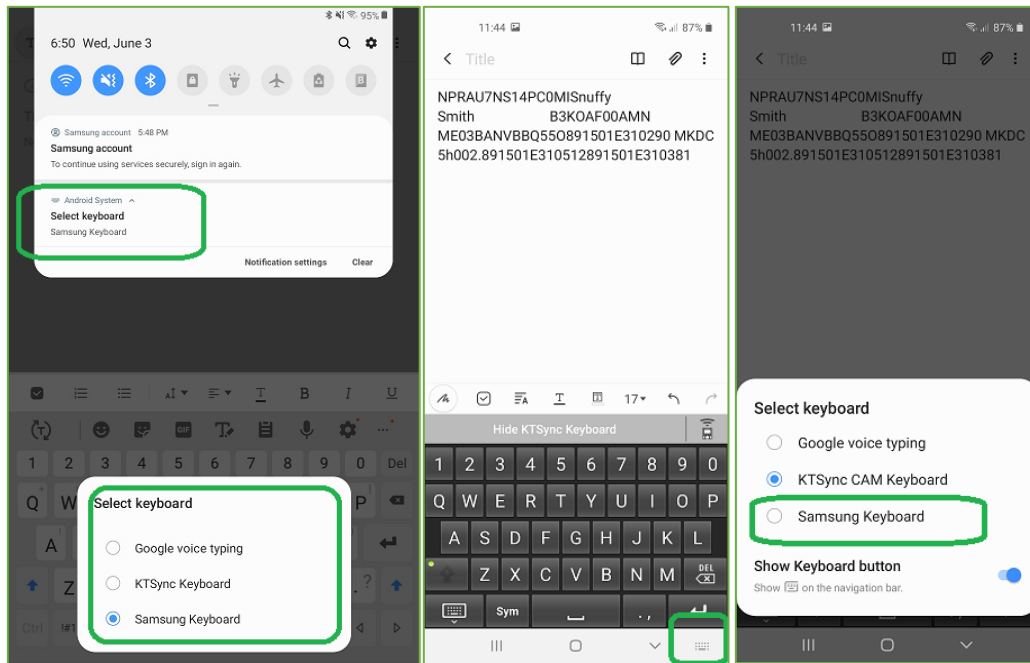

➤ **Read a barcode to the text-entry field of the application**

1. Find a scan icon from the keyboard and tap on the icon
2. The camera viewer will open then focus on the barcode. The camera will automatically read the barcode and send the barcode data to the text-entry field of the application.

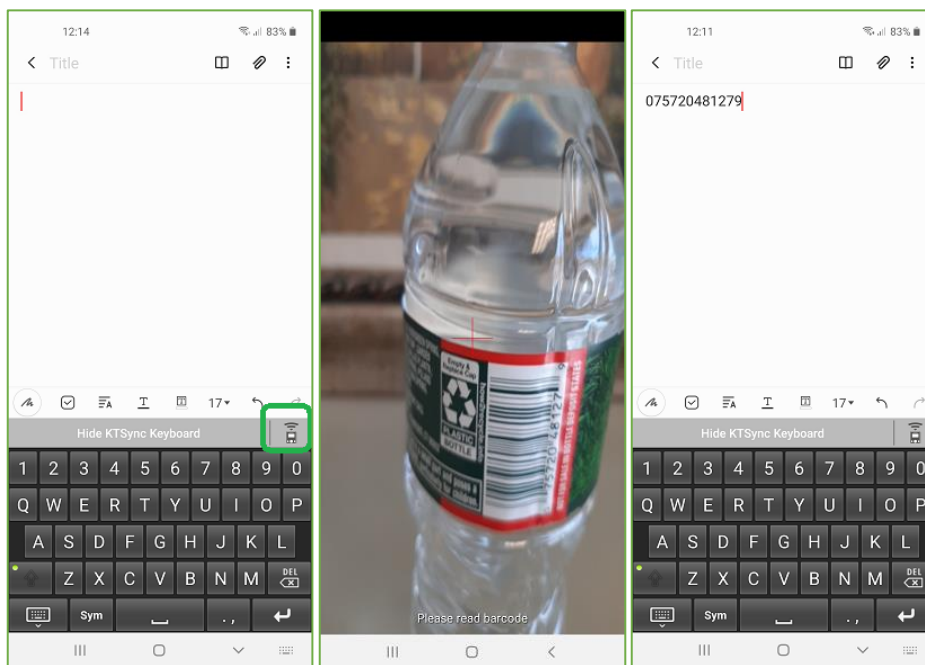

KOAMTAC (Android) KTSync CAM (SW Decoder) On-screen Keyboard

KTSync CAM Demo Feature (Scan & Search)

➤ Purpose

1. When you scan any barcode of any product or any logistics tracking, the selected retail/logistics website pops up and shows the searched result or the tracking information.

➤ How to test

1. Enable the demo mode first by enabling demo (Settings → Other Settings → Check “Enable Demo”)
2. And then select the demo type (demo store): FedEx, UPS, DHL Global, DHL US, Amazon, Walmart, The Home Depot, Lowes. (Settings → Other Settings → Demo Type) And tap “Home” icon at the right upper corner.

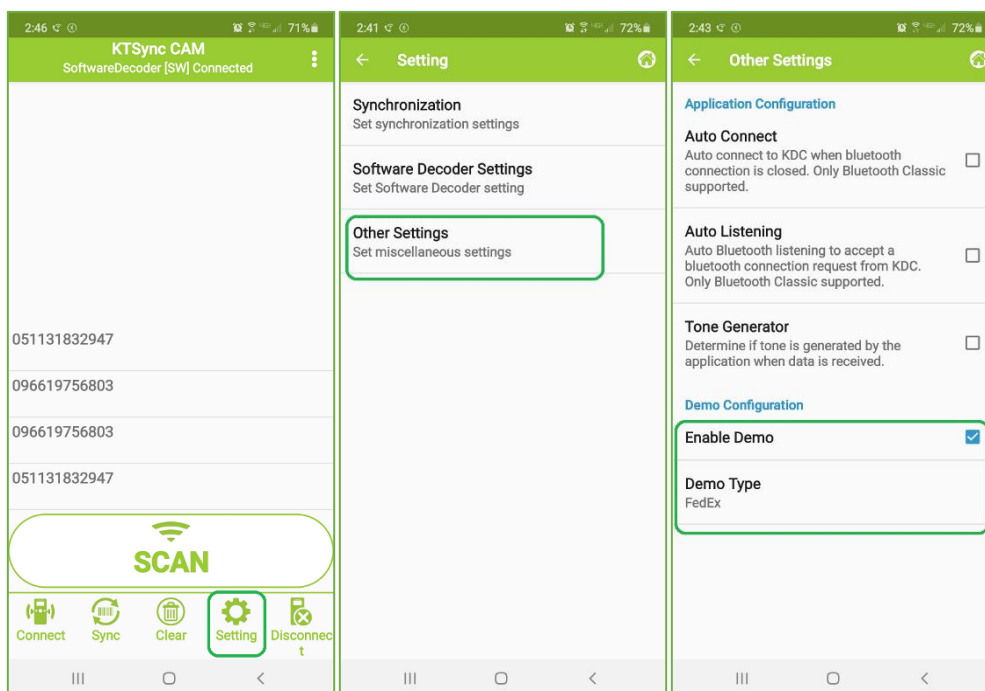

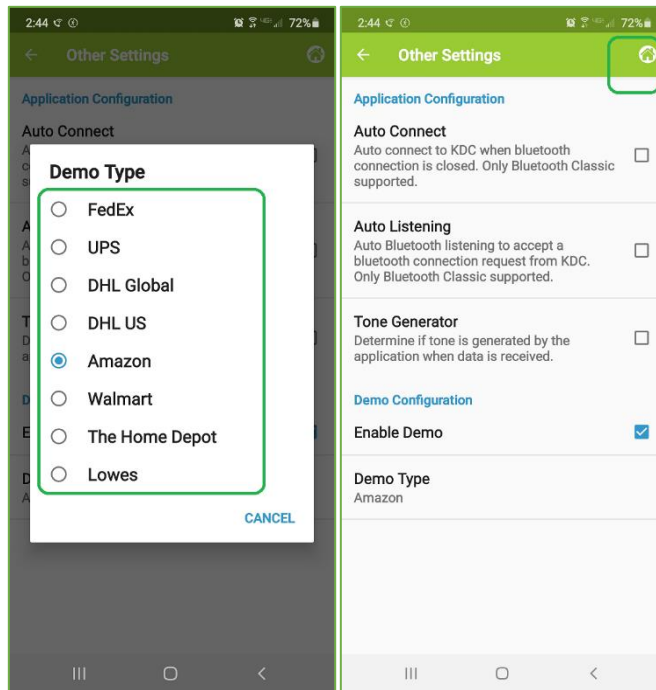

3. Now scan any barcode then the selected store website will pop up with a searched result.

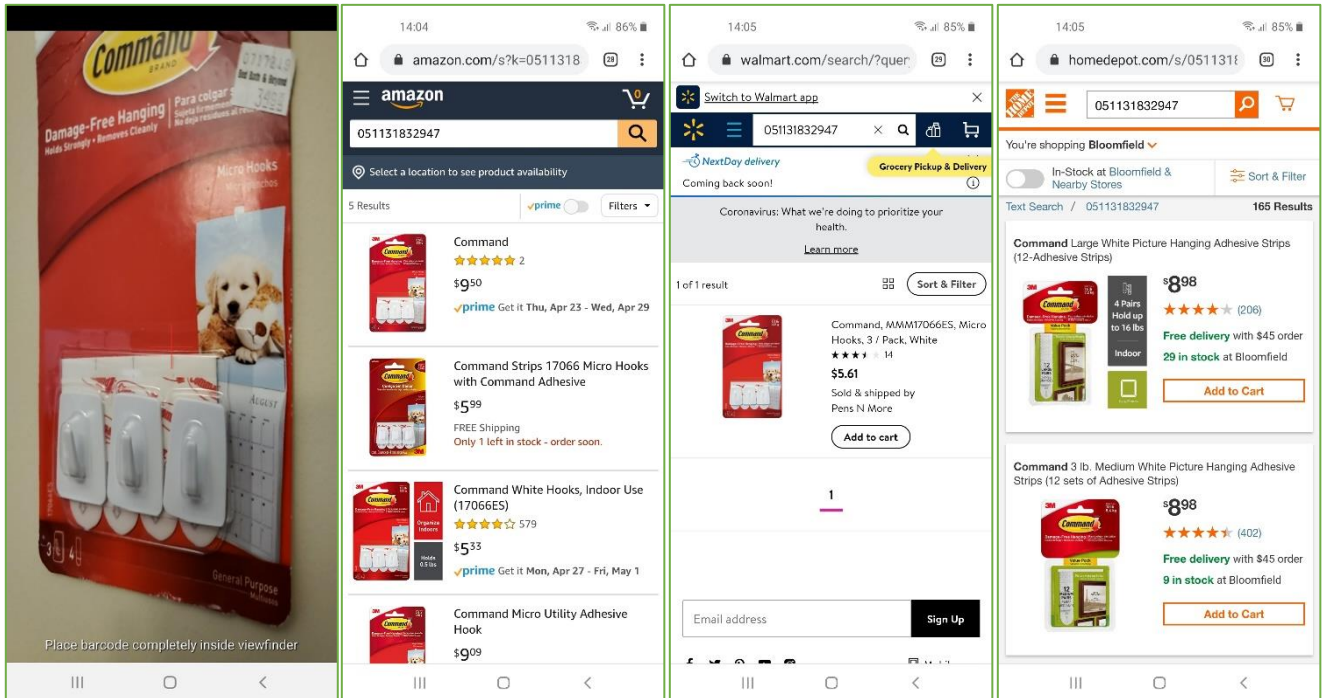

KOAMTAC (Android) KTSync CAM (SW Decoder) On-screen Keyboard

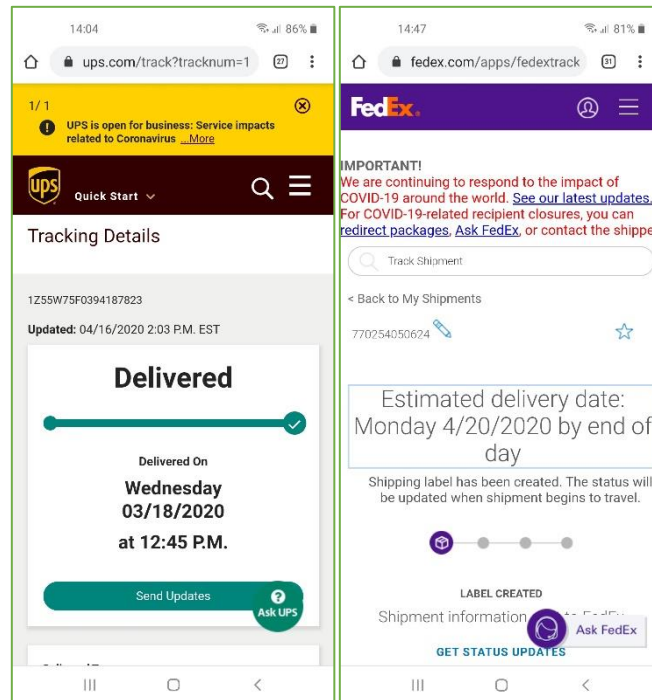

4. There are some example barcodes on the next page.

Sample Barcodes for Scan & Search Testing

UPS

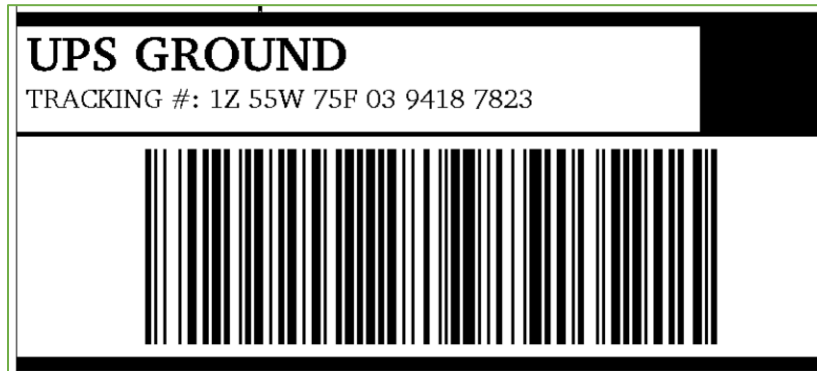

FedEx



Amazon/Walmart/Home Depot

