

What's in the Box?

- ▶ KDC100
- ▶ Protective Rubber Boot
- ▶ Ultra-Mini USB Cable
- ▶ KDC® Lanyard
- ▶ Quick Manual

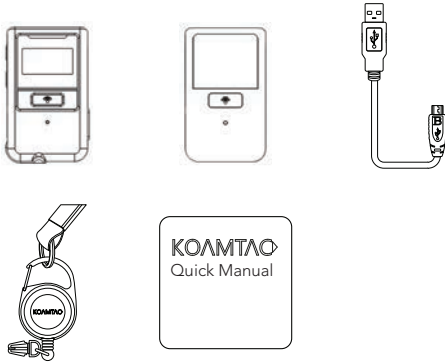

Additional Accessories

- ▶ Protective Rubber Boot
- ▶ 7-Port Charging Cradle
- ▶ 200mAh Battery
- ▶ Ultra-Mini USB Cable

KDC100 Models

- ▶ KDC100M Barcode Data Collector

Visit our website for more information.

KOAMTAC

116 Village Blvd, Ste 305, Princeton, NJ 08540
+1 609-256-4700 p | +1 609-228-4373 f
info@koamtac.com | www.koamtac.com

Basic Operation

1. Aim the KDC directly at the barcode and press the SCAN button, ensuring the beam covers the barcode horizontally.



2. A successful scan (A) will sound 1 beep, show a green LED, and display the scanned info on the screen. An unsuccessful scan (B) will sound 2 beeps, show a red LED, and display "Read Failed" on the screen.

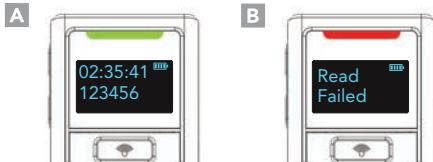

KTSync

KTSync® is a program which communicates with the KDC via Bluetooth.

It enables users to read and store data. KTSync is compatible with iOS, Android, Windows, and Mac. It also supports wedging and downloading data from the KDC.

For more information about KTSync, please visit:
www.koamtac.com/support/downloads/applications

SDK

The Software Development Kit (SDK) is the perfect solution for creating a custom application to collect data utilizing your KDC.

The KOAMTAC SDK covers all major development platforms: Android, iOS, Tizen, Windows, Xamarin, and Cordova. Developers may take advantage of the complimentary SDK and enjoy the full benefits of the KOAMTAC Developer Program.

For more information regarding the KOAMTAC Developer Program or to request the latest SDKs, visit:
www.koamtac.com/support/downloads/sdk
or e-mail sdk@koamtac.com.

Specs

Functionality

Memory Flash ROM: 256KB Program, 8MB User Data
Memory RAM: 64KB
Can store more than 400,000 Barcodes (EAN-13)

Symbologies

EAN-13, EAN-8, UPC-A, UPC-E, Code 39, ITF14,
Code 128, Interleaved 2 of 5, Codabar, GS1-128,
Code 93, Code 35, Bookland EAN-13, EAN-13/8 incl.
add on, UPCA/E incl. add on, GS1 Omni, GS1 Limited,
GS1 Expanded

Scan Range (10mil Code39)

1.97" to 7.48" (50 mm to 190 mm)

Helpful Barcodes

Factory Default and Reset



Specs

Interfaces

USB HID/Flash Memory
Swing-out USB Type A connector
Built-in Ultra-mini USB port

User Environment

Drop Spec: 4' (1.22 m) with protective boot
Operating: 32°F to 113°F (0°C to 45°C)
Storage: -4°F to 113°F (-20°C to 45°C)
Humidity: 5% to 85% (non-condensing)

Supporting OS

Mac OS X / Windows

Helpful Barcodes

Delete Last Scanned Barcode



KDC100 Diagram

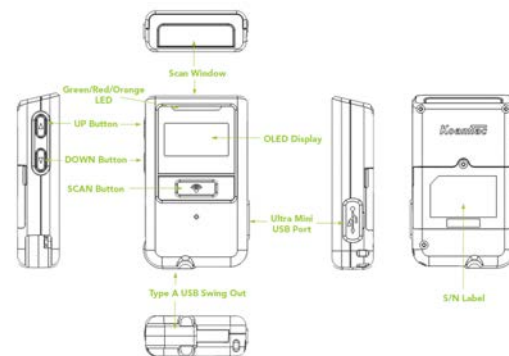

Helpful Barcodes

Enable Beep Sound



Disable Beep Sound

