

What's in the Box?

One (1) of the following devices:

- KDC470 KDCSLED-HF
- KDC475 KDCSLED-HF
- KDC470 KDCSLED-UHF0.5W
- KDC475 KDCSLED-UHF0.5W

And:

- 4 screws + 1 extra

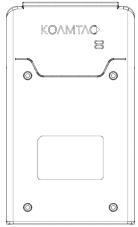

KDC470
KDCSLED-HF/UHF0.5W

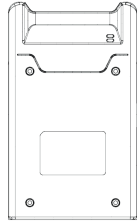

KDC475
KDCSLED-HF/UHF0.5W



*KDC470/475 sold separately. Tweezers and PH0 screwdriver (not included) will be necessary to complete assembly.

Additional KDC470/475 Accessories:

- Charging Cradle (1-Slot, 4-Slot)

KOAMTAC

116 Village Blvd, Ste 305, Princeton, NJ 08540
+1 609-256-4700 p | +1 609-228-4373 f
info@koamtac.com | www.koamtac.com

KOAMTAC

KDC470/475
KDCSLED-HF/KDCSLED-UHF0.5W
Assembly Manual

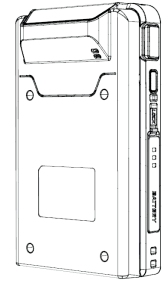
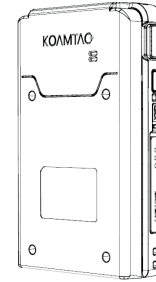

*KDC470 KDCSLED-HF/UHF0.5W and KDC475 KDCSLED-HF/UHF0.5W are assembled the same way.

Assembly Instructions

1. Using tweezers, carefully remove all four (4) screw caps from back of KDC470/475. (A)

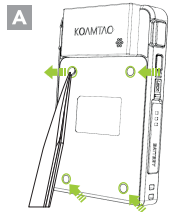

2. Remove all four (4) screws from back of KDC470/475. (B)

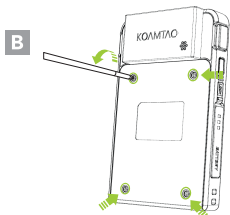

3. Remove back cover of KDC470/475. (C)

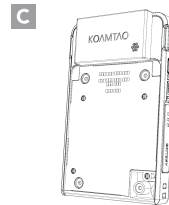

4. Remove blue protective film from KDCSLED-HF/UHF0.5W. (D)

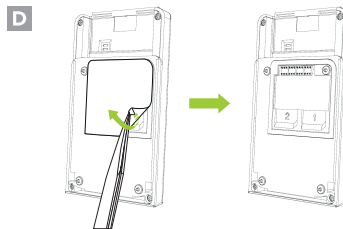

5. Align screw holes of KDC470/475 with the screw holes of the KDCSLED-HF/UHF0.5W. (E)

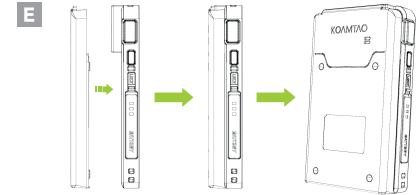

6. Use the four (4) included screws to tighten KDCSLED-HF/UHF0.5W to KDC470/475 as shown below. (F)

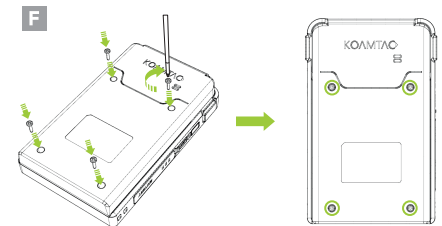

Enabling NFC Power

Enable NFC Power



Disabling NFC Power

Disable NFC Power



Single Read Mode

Only one tag is read every time the scan button is pressed.

* 1 short beep occur when changing mode with Down key.

Single Read Mode



Toggling Read Modes

There are two read modes in which the SCAN button works and they are toggled by pressing UP button for 3 seconds.

- Barcode Mode: When entered into this mode, 1 long and 1 short beep will be heard. Barcodes can be read with the SCAN button.
- Tag Reading Mode: When entered into this mode, 1 long and 2 short beeps will be heard. UHF tags can be read with the SCAN button.

Multiple Read Mode

When the Scan button is pressed, multiple tags are read simultaneously for the set time (default 10 seconds).

- * Time setting can be changed in Settings ->Reading Timeout.
- * 2 short beeps will occur when changing mode with Down key.

Multiple Read Mode



Changing Tag Read Mode

The tag read mode is changed by scanning one of the following barcode or by pressing the Down key of KDC470/475 for 3 seconds in RFID mode.

The order is changed to in the following order:
Active (default) read -> Single read -> Multiple read

Active Read Mode

Basic operation status. Simultaneous reading of multiple tags while pressing the scan button (max. 10 minutes).

* 3 short beeps will occur when changing mode with Down key.

Active Read Mode



View of Assembled Product

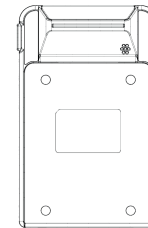

KDC475

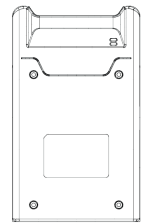

KDC475
KDCSLED-HF/UHF0.5W

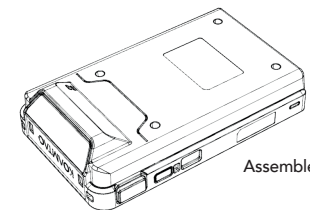

Assembled View